

15.14 Acres I-1 Land



2425 W. 58th Street North
Sioux Falls, SD 57107

Property Features

- Lot size: 15.14 acres
- Zoning: I-1
- An additional 9.9 acres of land could be added to south of this parcel
- Located in an Opportunity Zone

Pricing

- List price: \$3.90/ sq. ft. (\$2,572,043.76)
- 2019 Real Estate Taxes: TBD

Location

- Located just south 60th Street N
- Easy access to I-29 and I-90
- Area neighbors include: Sanford Sports Complex, J&L Harley Davidson, Vern Eide Motorplex, Beal Distributing

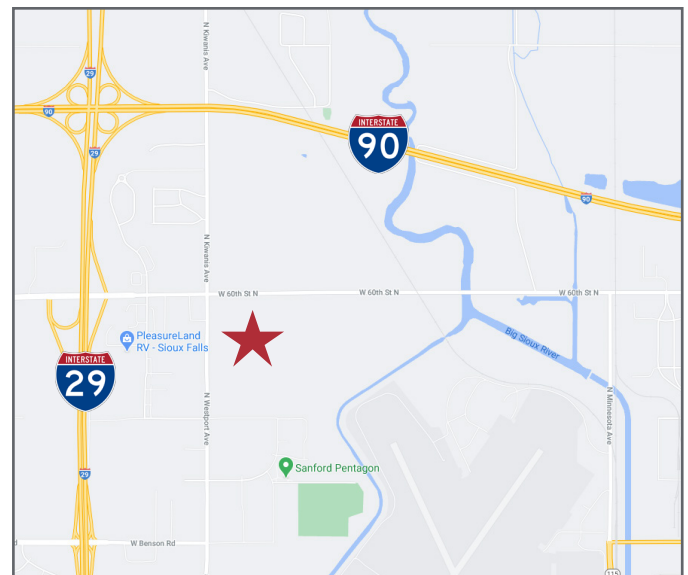

Craig Hagen, CCIM, SIOR
Senior Vice President

605 310 4227 • chagen@naisiouxfalls.com

2500 W. 49th Street Suite 100

Sioux Falls, SD 57105

+1 605 357 7100

naisiouxfalls.com

NO WARRANTY OR REPRESENTATION, EXPRESS OR IMPLIED, IS MADE AS TO THE ACCURACY OF THE INFORMATION CONTAINED HEREIN, AND THE SAME IS SUBMITTED SUBJECT TO ERRORS, OMISSIONS, CHANGE OF PRICE, RENTAL OR OTHER CONDITIONS, PRIOR SALE, LEASE OR FINANCING, OR WITHDRAWAL WITHOUT NOTICE, AND OF ANY SPECIAL LISTING CONDITIONS IMPOSED BY OUR PRINCIPALS NO WARRANTIES OR REPRESENTATIONS ARE MADE AS TO THE CONDITION OF THE PROPERTY OR ANY HAZARDS CONTAINED THEREIN ARE ANY TO BE IMPLIED.

