

3,880 Sq. Ft. Spec Building



Jackson Spec Building

2924 E. Jackson Street, Sioux Falls, SD 57108

Property Features

- Building size: 3,880 sq. ft.
- Building is designed to be subdivided into two +/- 1,940 sq. ft. suites
- SBA 504 loan ready building can accommodate a 51% owner-occupant
- Investment potential with an office tenant that needs any size of space
- Excellent location in southeast Sioux Falls with quick access to 69th & Southeastern
- Pick your own finishes! Several options for tenant/buyer to choose from
- Space sheet-rocked, taped, and textured
- Allow 6-8 weeks for delivery after going under contract

Pricing

- List price: \$850,000 (\$219.07/ sq. ft.)
- Lease rate: \$17.00/ sq. ft. NNN
- Estimated NNN: \$5.00/ sq. ft.

Location

- Located just north of the roundabout of 69th Street and S. Southeastern Avenue
- Area neighbors include: GreatLife Performance & Fitness, Sioux Falls Christian Schools, Harrisburg Horizon Elementary School, Wings Gymnastics Academy

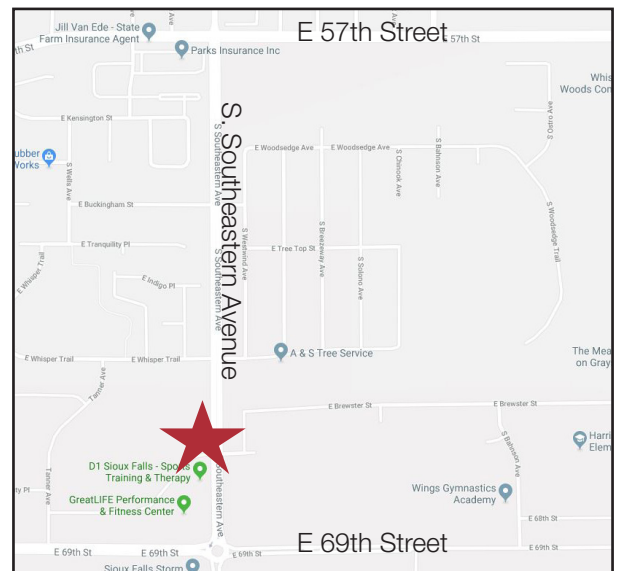

For more information:

Marcus Mahlen, CCIM

+1 605 228 9744 • mmahlen@naisiouxfalls.com

Troy Fawcett, CCIM, SIOR

+1 605 321 2199 • tfawcett@naisiouxfalls.com

Current layout. Space is framed, sheet-rocked, taped and textured. Ready for carpet and paint selections by buyer/tenant. 6-8 weeks for completion after going under contract.

FOR SALE OR LEASE

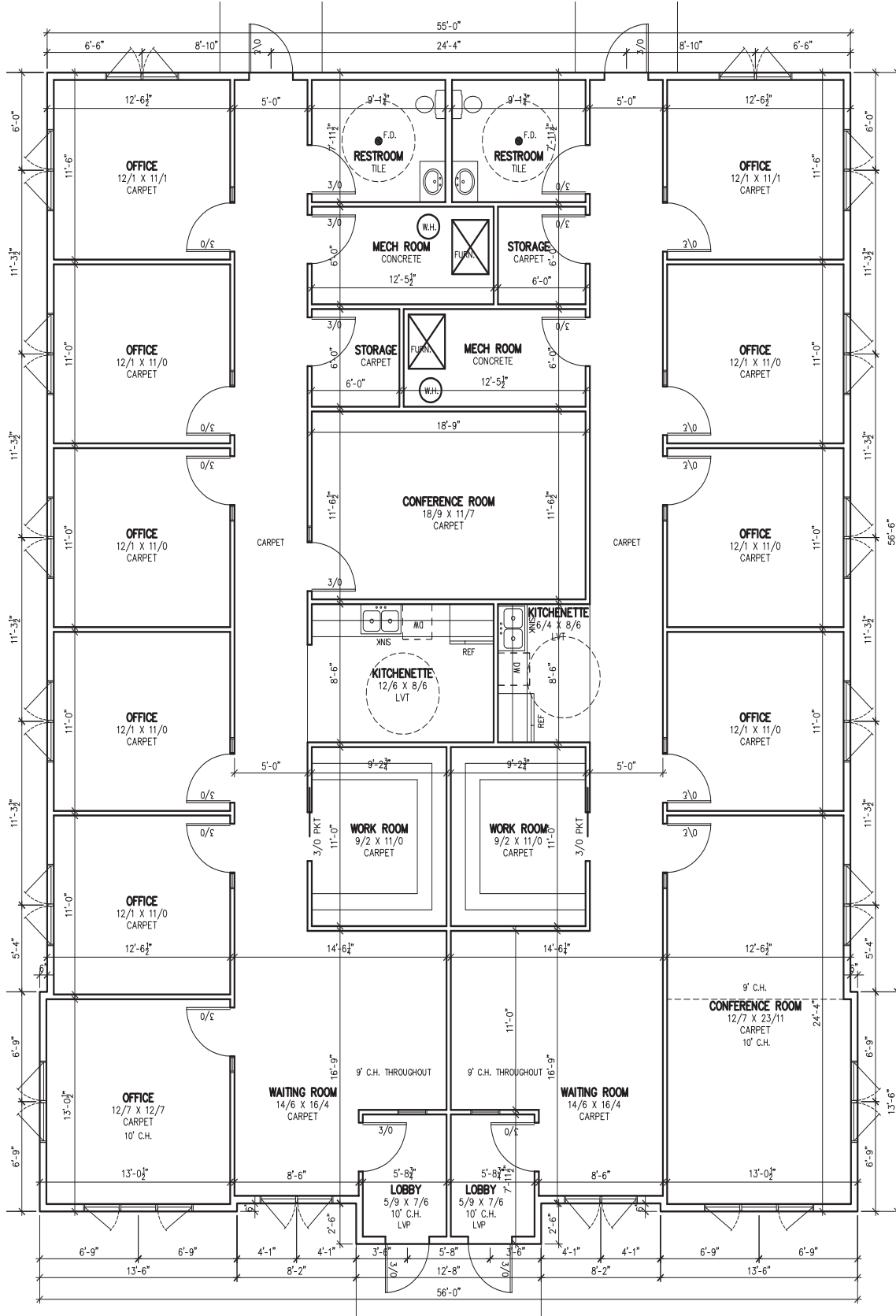



FOR SALE OR LEASE

Interior rendering

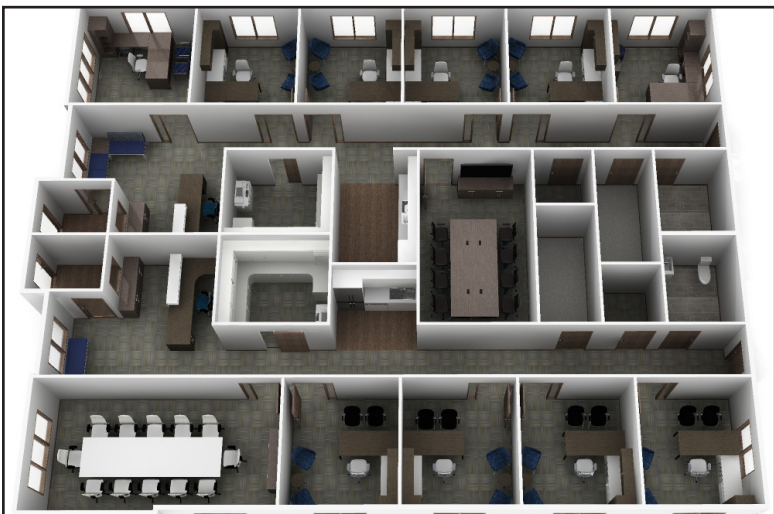
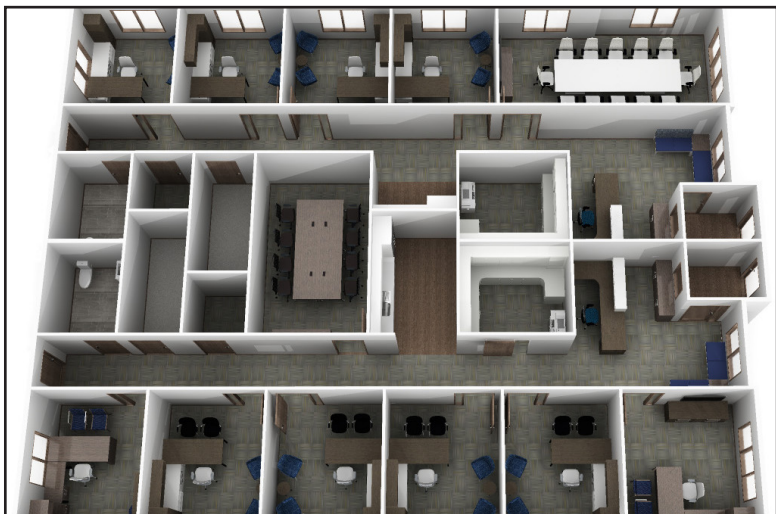

NA Sioux Falls

2500 W. 49th Street Suite 100
Sioux Falls, SD 57105
+1 605 357 7100
naisiouxfalls.com

