



Louise Avenue Retail

2520 S. Louise Avenue, Sioux Falls, SD

Property Features

- Excellent owner/occupant opportunity
- Building size: 11,364 sq. ft.
- Available suite size: 4,705 sq. ft. & 6,659 sq. ft.
- Year built: 2002
- Lot size: 54,931 sq. ft. (1.26 acres)
- Paved on-site parking
- Monument and building signage
- Zoning: C-4

Pricing

- List Price: Contact broker
- 2020 Real Estate Taxes are \$36,837.94

Location

- Located on S. Louise Ave. across from Culvers
- High traffic location
-2018 Traffic Count: 15,400 vehicles per day
- High visibility and access in major retail corridor

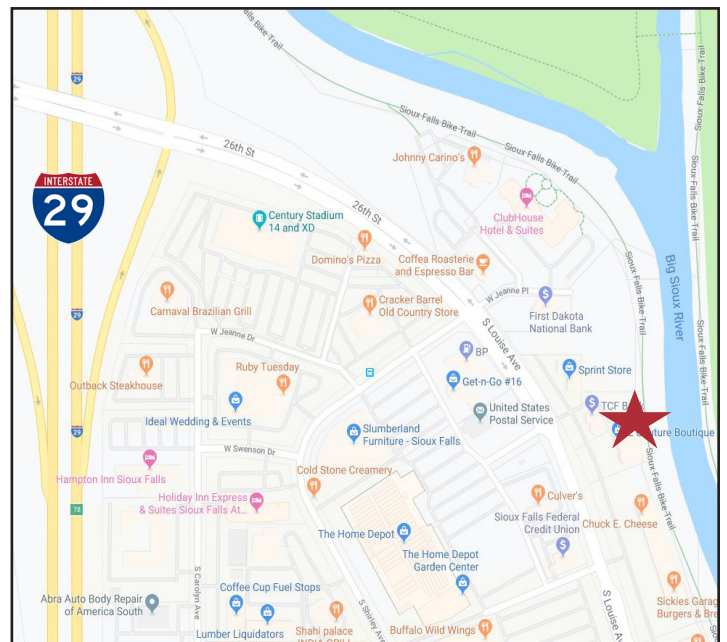

Ryan Ammann

+1 605 444 7131 Office

+1 605 310-7091 Cell

rammann@naisiouxfalls.com

For Sale or Lease
Retail Strip Center

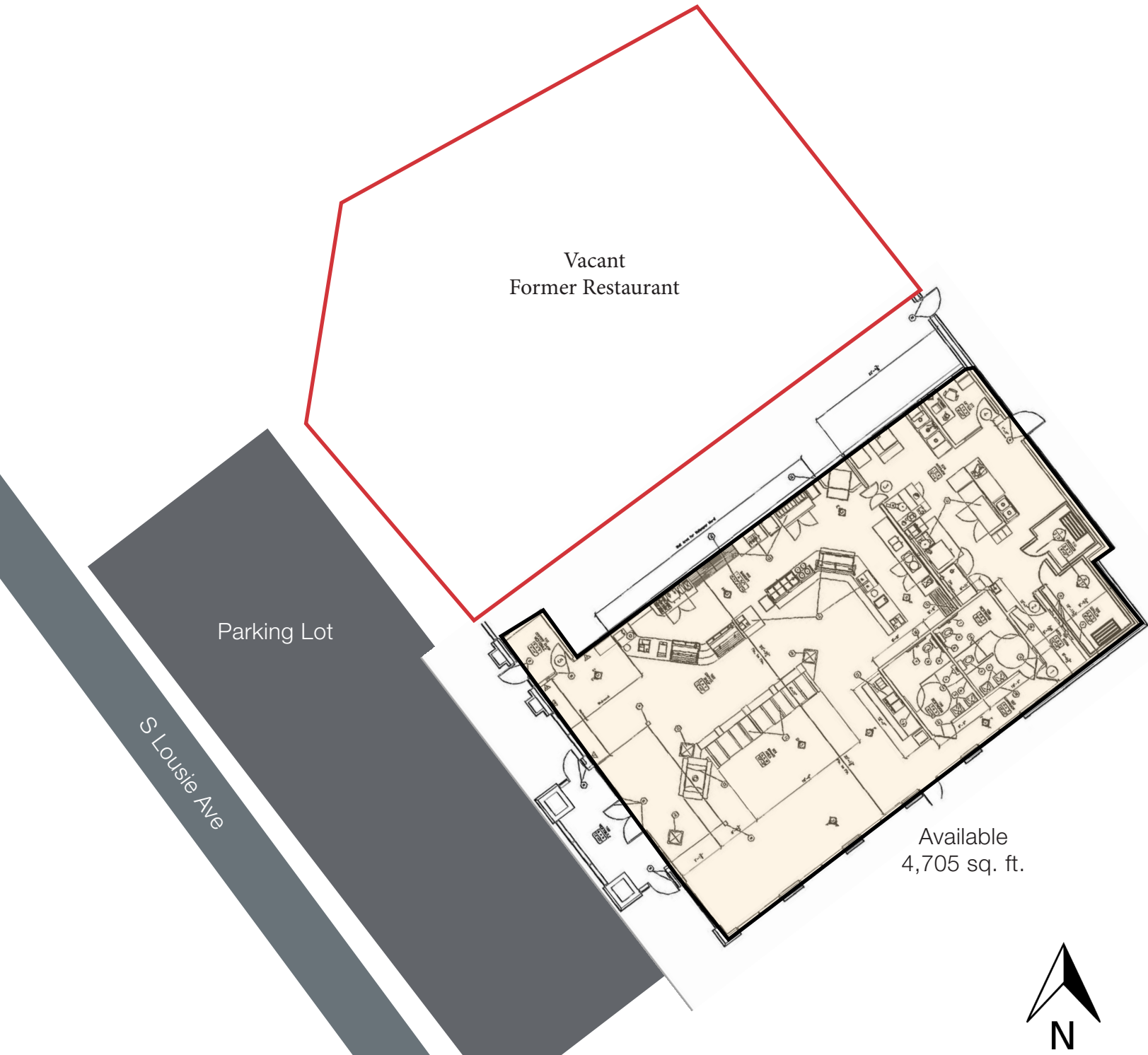

For Sale or Lease
Retail Strip Center



For Sale or Lease
Retail Strip Center

